

Cage Panel Connections Reduction

Instruction No.: SP45/50_CI02

Product: SP45/50

Operation: Rewire CH1 & CH2 on the cage console PCB

Health & Safety Considerations:



Standard Practices Only

Tools Required: Pozi-screwdriver (PH-2), Terminal Screwdriver, Flush Cutters, Wire Strippers, Crimp Tool

Consumables Required: Red Butt Splice Crimps, 4.6x200mm Cable Ties

Parts Required: None

Notes/Other References:

[Disclaimer](#)

All update activities should be carried out by a competent MEWP service technician adhering to standard health and safety practices.

Whilst every effort has been made to include all information and details required to facilitate the mentioned updates should you have any queries contact the Niftylift Service department via service@niftylift.com.

1. Gain access to the cage console PCB

Using a PH-2 Pozzi screwdriver remove the console lid by unscrewing the 6x fastening bolts (fig.1 & fig.2 & fig.3), and flip the console panel over to expose the PCB board (fig.4).

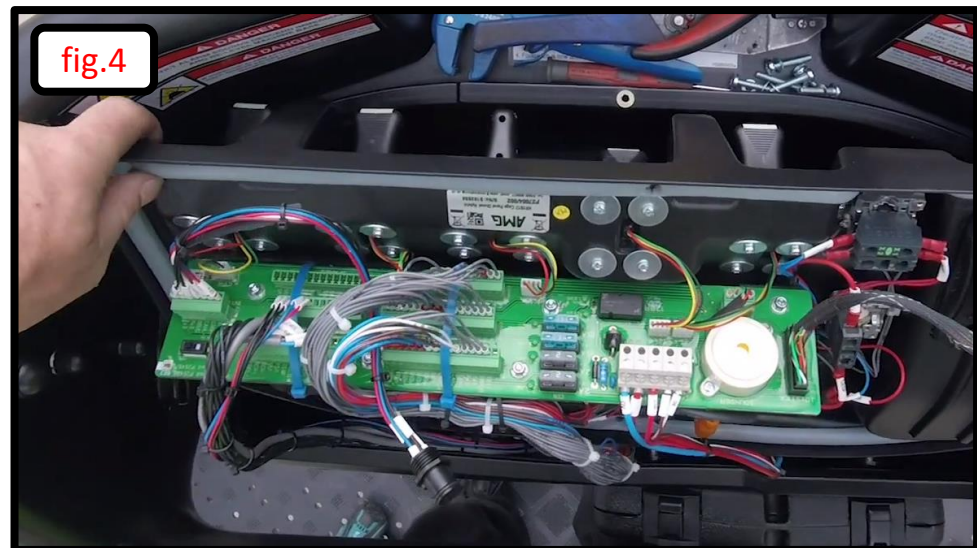

2. Remove CONN 17 & CONN 13

Cut both of the connector tie down cable ties (fig.1 & fig.2). Remove CONN17 & CONN 13 from the PCB (fig.3).

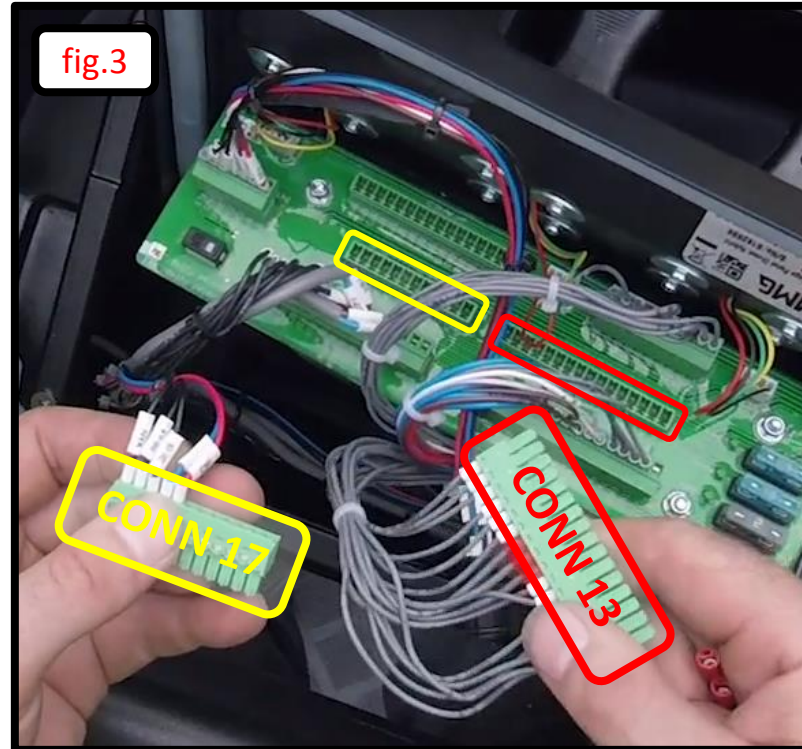
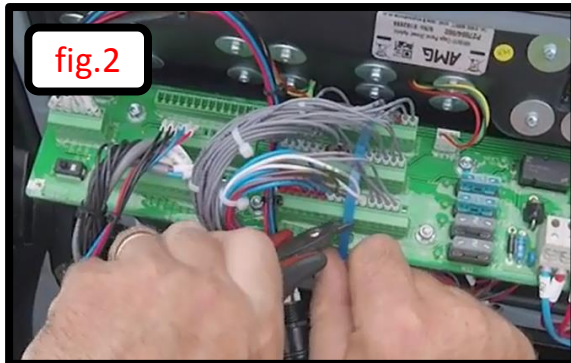
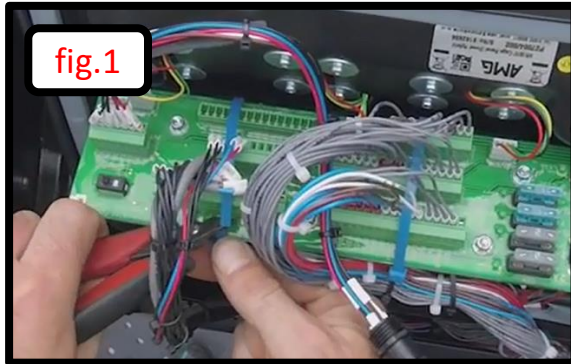

3. Join CH1 from CONN 17 & CONN 13 together

Remove CH1 from CONN 17 (3rd in from the left) (fig.1) & CONN 13 (3rd in from the left) (fig.2) . Cut off the ferrules on each (fig.3) and butt crimp together (fig.4).

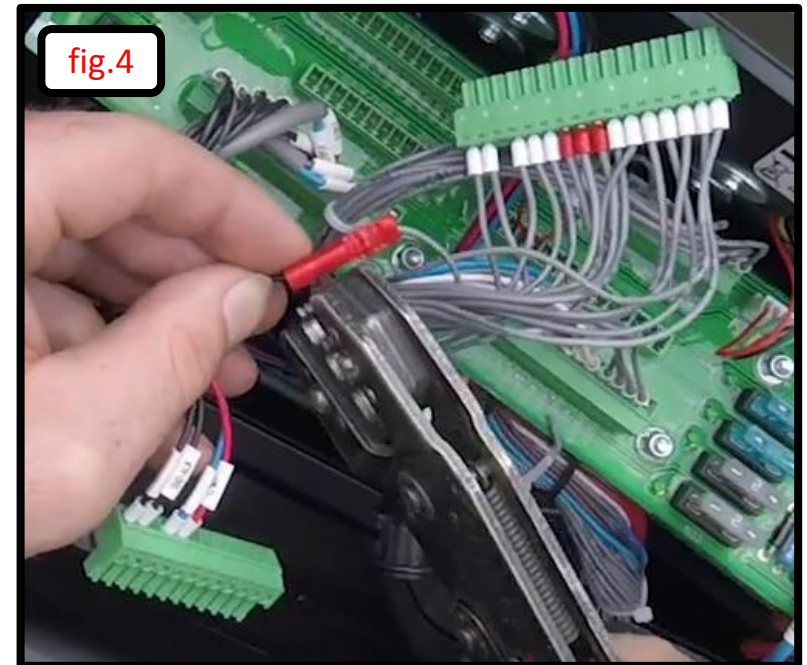
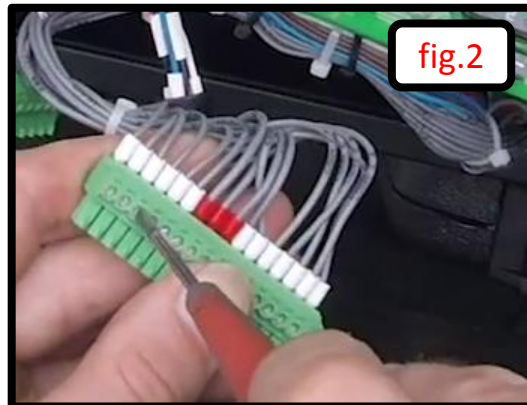
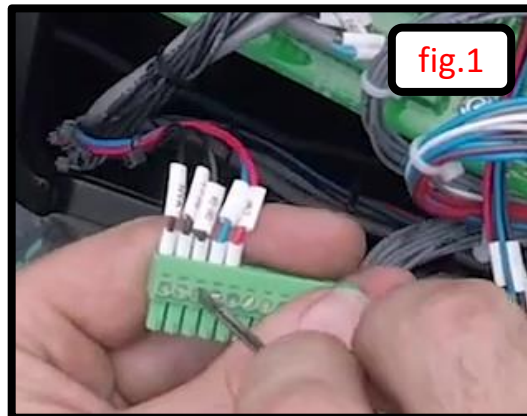

4. Join CH2 from CONN 17 & CONN 13 together

Remove CH2 from CONN 17 (2nd in from the left) (fig.1) & CONN 13 (4th in from the left) (fig.2) . Cut off the ferrules on each (fig.3) and butt crimp together (fig.4).

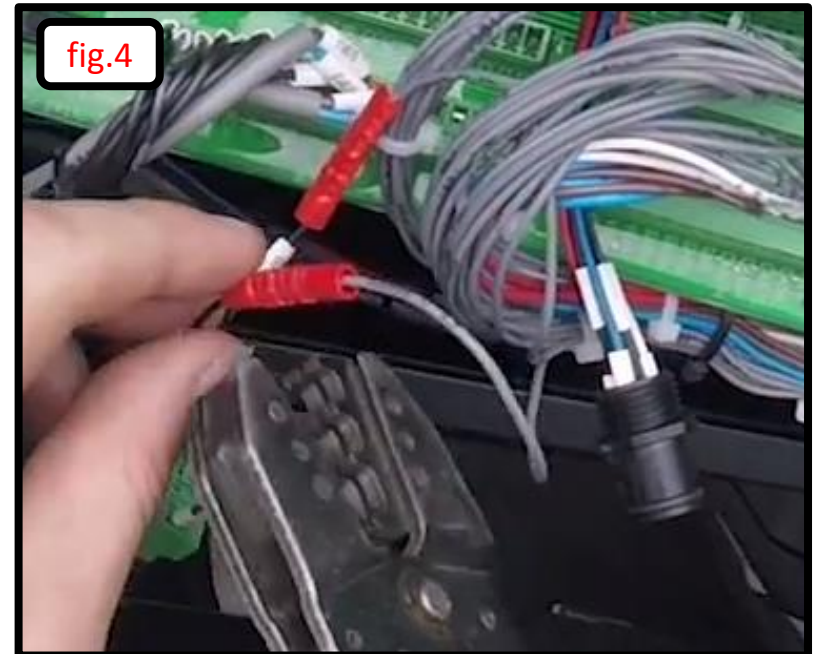
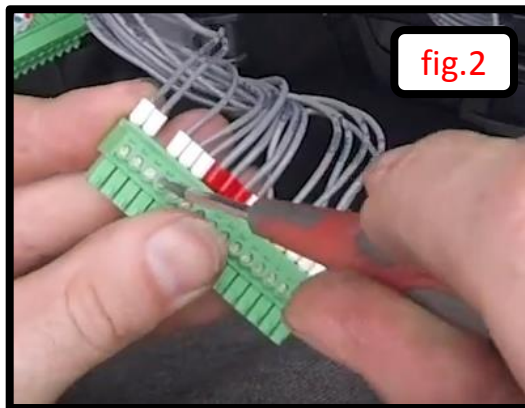
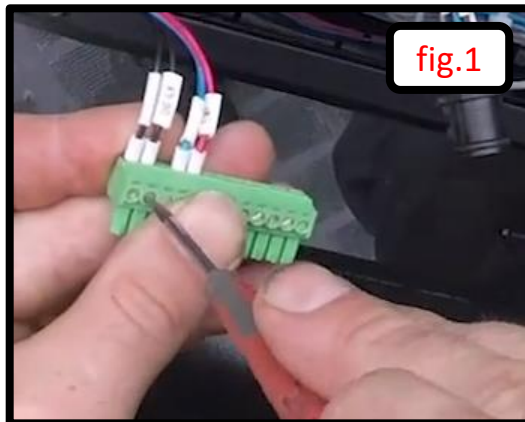

5. Reassembly the cage console

Plug and cable tie CONN 17 & CONN 13 back into the PCB (fig.1) . Reattach the console panel to the cage assembly (fig.2 & fig.3 & fig.4).

