

**Cage Panel Connections Reduction**

**Instruction No.:** HR15/17\_CI02

**Product:** HR15/17

**Operation:** Rewire CH1 & CH2 on the cage console PCB

**Health & Safety Considerations:**



Standard Practices Only

**Tools Required:** Pozi-screwdriver (PH-2), Terminal Screwdriver, Flush Cutters, Wire Strippers, Crimp Tool

**Consumables Required:** Red Butt Splice Crimps, 4.6x200mm Cable Ties

**Parts Required:** None

**Notes/Other References:**

[Disclaimer](#)

All update activities should be carried out by a competent MEWP service technician adhering to standard health and safety practices.

Whilst every effort has been made to include all information and details required to facilitate the mentioned updates should you have any queries contact the Niftylift Service department via [service@niftylift.com](mailto:service@niftylift.com).

## 1. Gain access to the cage console PCB

Using a PH-2 Pozzi screwdriver remove the console lid by unscrewing the 6x fastening bolts (fig.1 & fig.2 & fig.3), and flip the console panel over to expose the PCB board (fig.4).

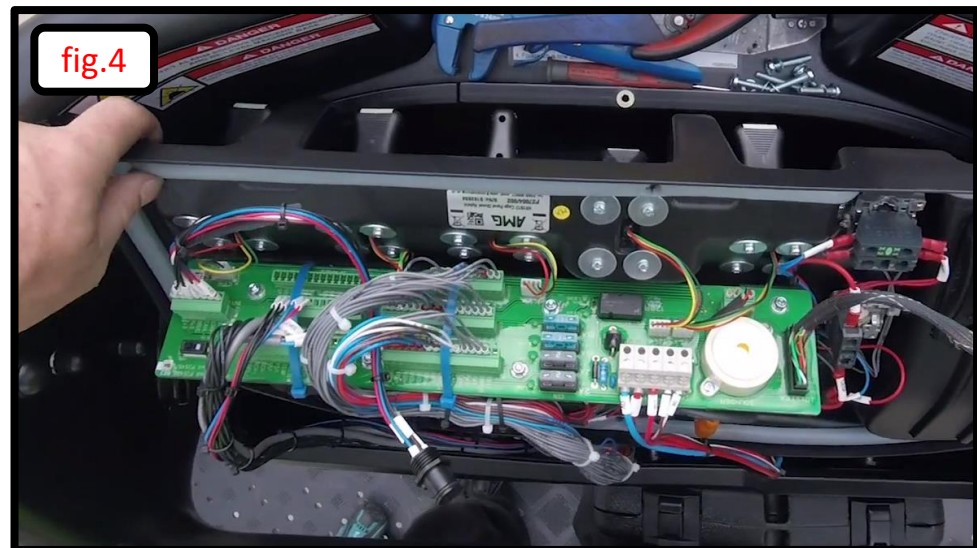

## 2. Remove CONN 17 & CONN 13

Cut both of the connector tie down cable ties (fig.1 & fig.2). Remove CONN17 & CONN 13 from the PCB (fig.3).

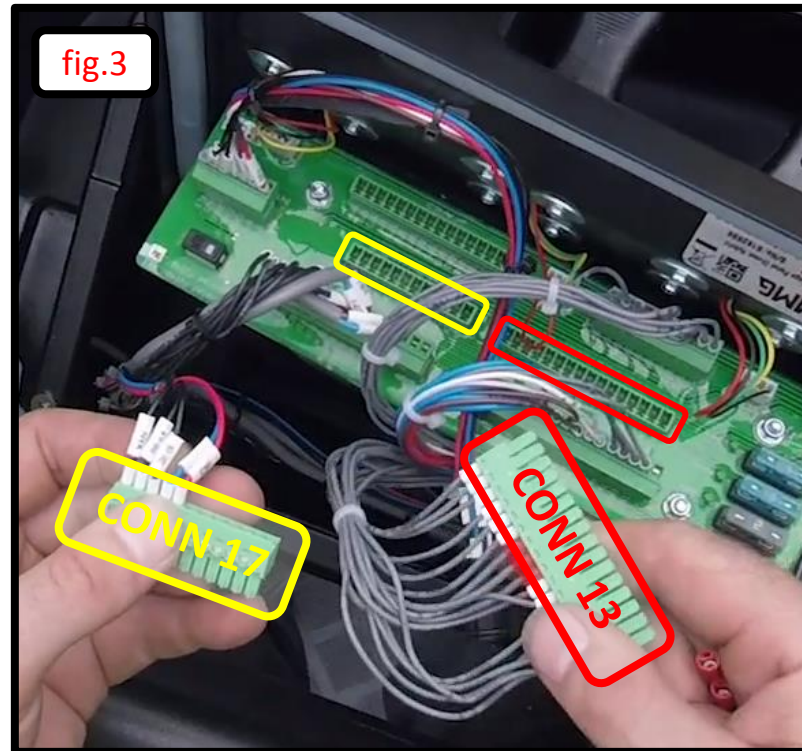
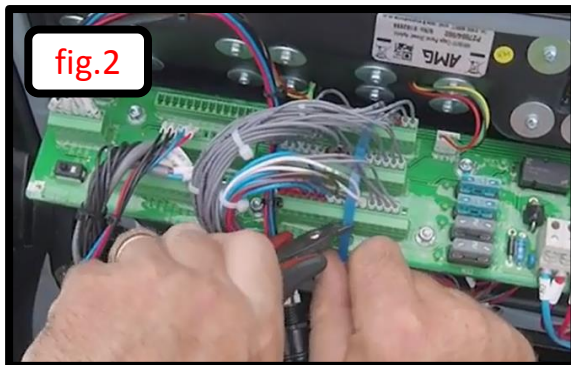
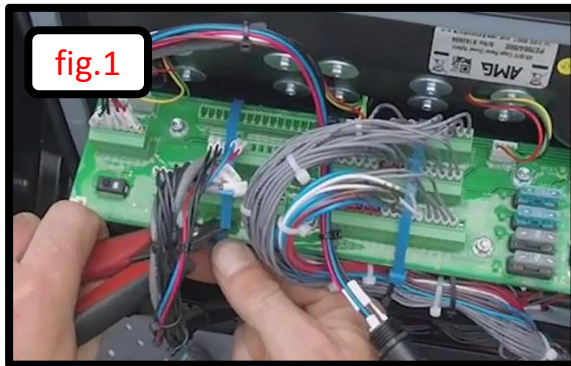

### 3. Join CH1 from CONN 17 & CONN 13 together

Remove CH1 from CONN 17 (3<sup>rd</sup> in from the left) (fig.1) & CONN 13 (3<sup>rd</sup> in from the left) (fig.2) . Cut off the ferrules on each (fig.3) and butt crimp together (fig.4).

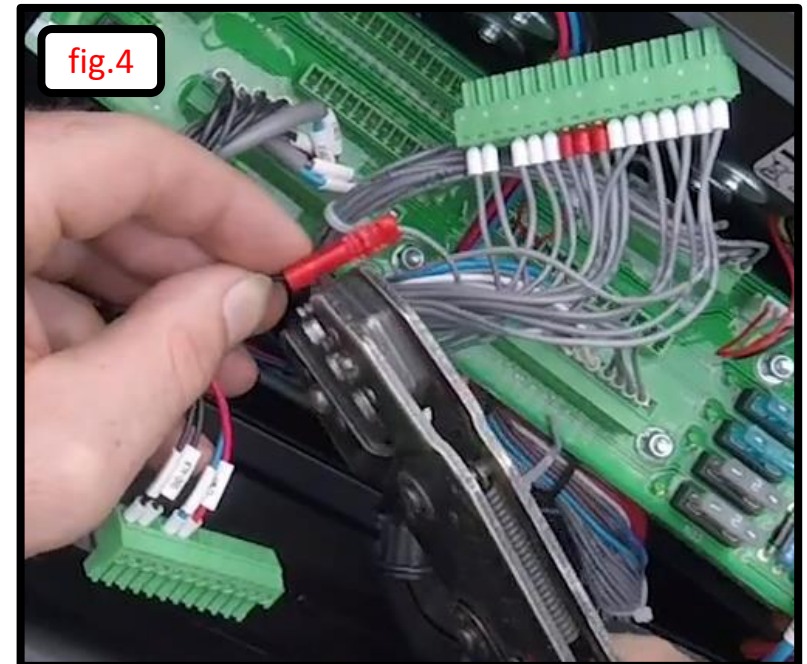
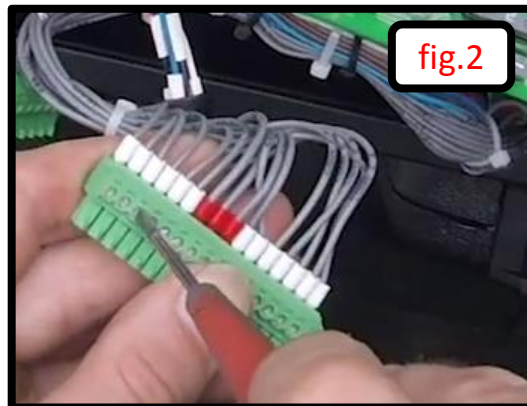
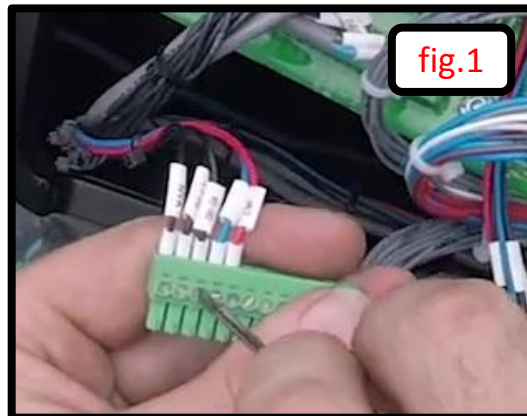

## 4. Join CH2 from CONN 17 & CONN 13 together

Remove CH2 from CONN 17 (2<sup>nd</sup> in from the left) (fig.1) & CONN 13 (4<sup>th</sup> in from the left) (fig.2) . Cut off the ferrules on each (fig.3) and butt crimp together (fig.4).

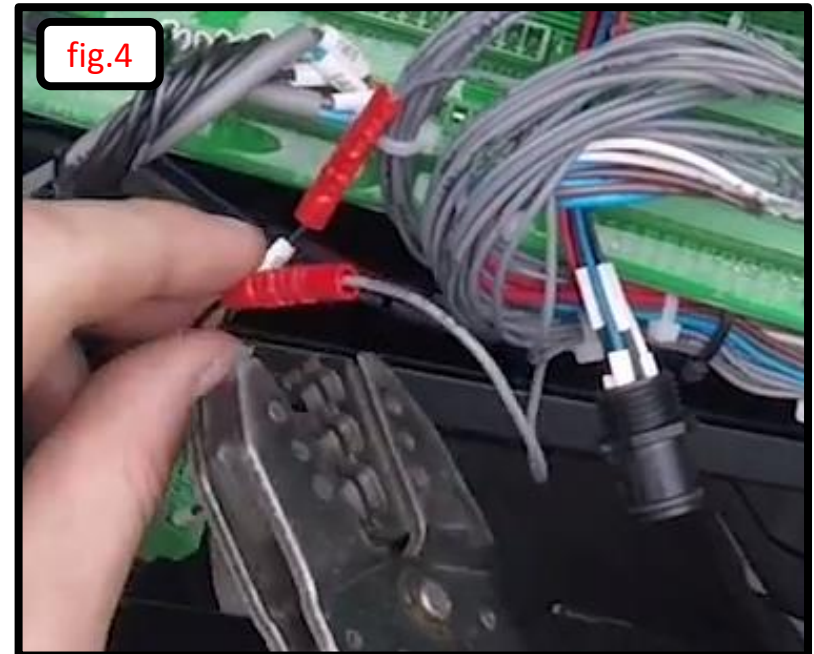
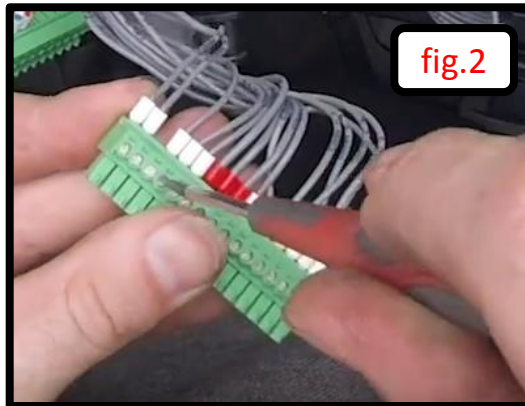
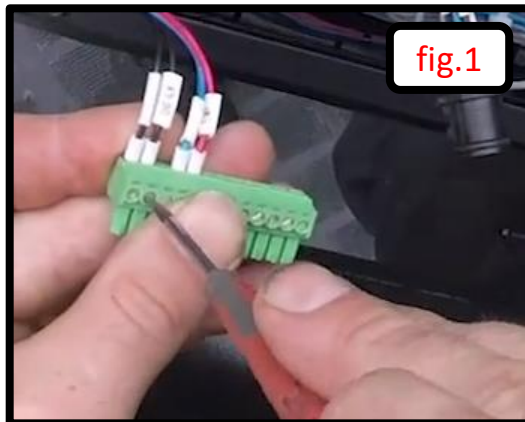

## 5. Reassembly the cage console

Plug and cable tie CONN 17 & CONN 13 back into the PCB (fig.1) . Reattach the console panel to the cage assembly (fig.2 & fig.3 & fig.4).

